



**RECORD OF TITLE
UNDER LAND TRANSFER ACT 2017
LEASEHOLD
Search Copy**



R. W. Muir
Registrar-General
of Land

Identifier SA21B/158
Land Registration District South Auckland
Date Registered 01 November 1976 12:00 am

Prior References
SA20C/282

| | | | |
|--------------------------|-----------------------------------------------|-------------------|-------------------------|
| Estate | Leasehold | Instrument | L H105551.1 |
| Legal Description | Flat A Deposited Plan South Auckland 23137 | Term | 999 years from 1.9.1976 |

Registered Owners
Talia Jane Ormsby

Interests

B230145.3 Variation of Lease H105551.1 - 23.9.1994 at 11.02 am
13211027.3 Mortgage to ANZ Bank New Zealand Limited - 4.2.2025 at 2:45 pm

18-9-1995

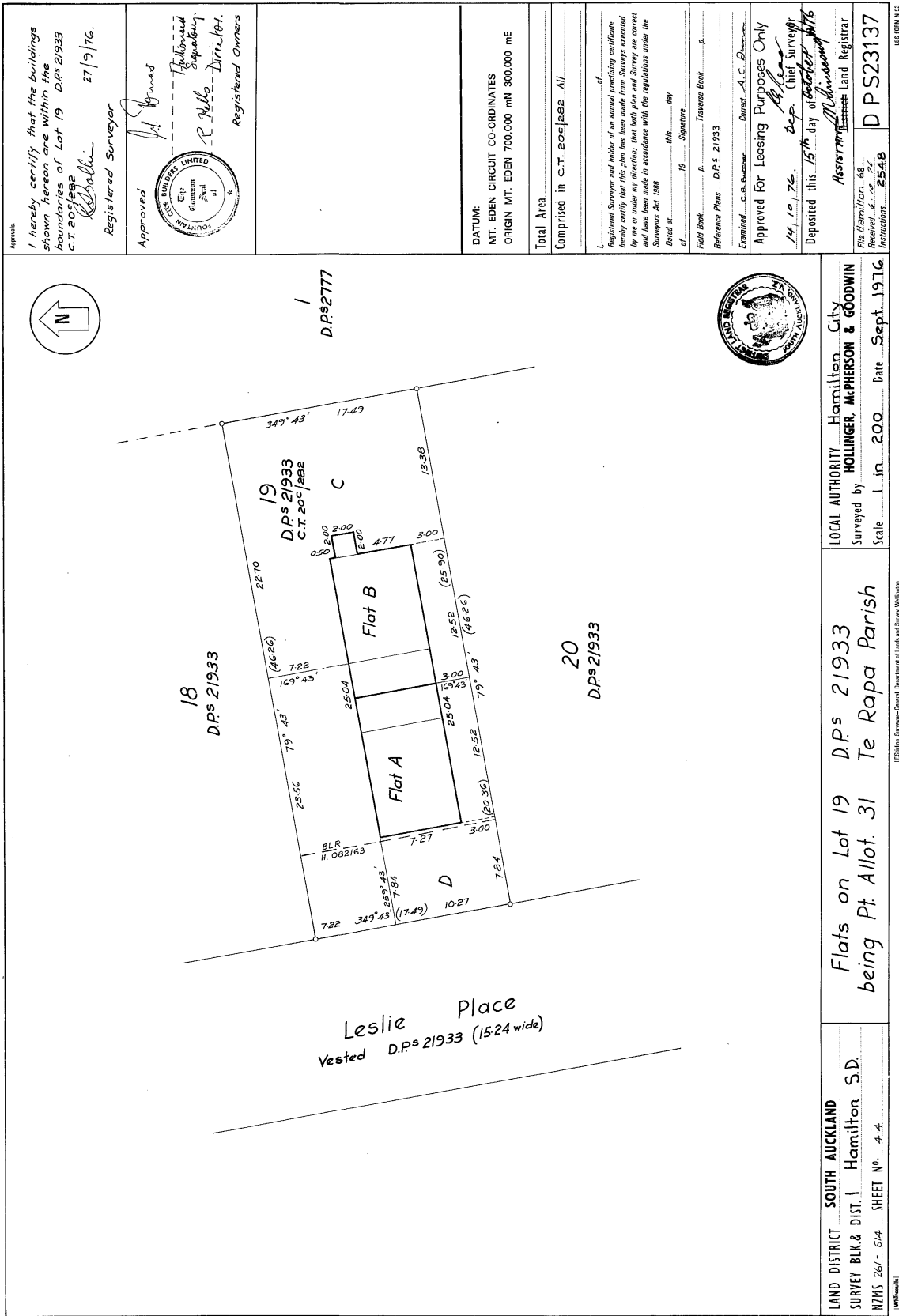

I hereby certify that the buildings shown hereon are within the boundaries of Lot 19 D.P.s 21933 C.T. 20c/1882
27/9/76.
Registered Surveyor
Approved
R. M. M. Director.
Registered Owners



DATUM:
MT. EDEN CIRCUIT CO-ORDINATES
ORIGIN MT. EDEN 700,000 mN 300,000 mE

Total Area
Comprised in C.T. 20c/1882 All

Registered Surveyor and holder of an annual practicing certificate hereby certify that this plan has been made from surveys executed by me or under my direction. That all bearings and distances are correct and that the plan is in accordance with the regulations under the Surveyors Act 1986
Dated at _____ this _____ day of _____ 19 _____ Signature _____

Field Book _____ p. _____ Transverse Book _____ p. _____
Reference Plans _____ D.P.s 21933.
Examined _____ C.A. G. _____ District A.C. G. _____

Approved For Leasing Purposes Only
14/10/76. Dep. Chief Surveyor
Deposited this 15th day of October 1976
Asst. Registrar

File Hamilton 68
Instructions 254B
D P S 213137

LOCAL AUTHORITY Hamilton City
Surveyed by HOLLINGER, McPHERSON & GOODWIN
Scale 1 in 200 Date Sept. 1976

Flats on Lot 19 D.P.s 21933
being Pt. Allot. 31 Te Rapa Parish

SOUTH AUCKLAND
LAND DISTRICT DIST. 1 Hamilton S.D.
N/ZMS 26/1-514 SHEET No. 4-4

LS 100A N 33

1:50 Scale, Surveyor-General, Department of Lands and Survey, Wellington

MS 5000